

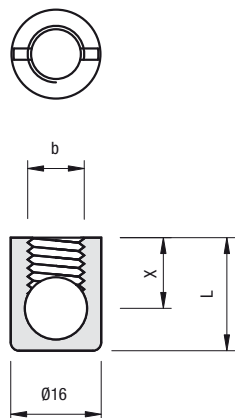

Barilotto Ø 16 senza bordo

Housing Ø 16 wo/rim



	ART.	∅	X	b	L		
Zama	301	22	16	11	10MA	19,5	2.000
	302	24-25	16	12	10MA	20,5	2.000
	303	26-28	16	13	10MA	21,5	2.000

Barilotto Ø 16 con bordo

Housing Ø 16 w/rim

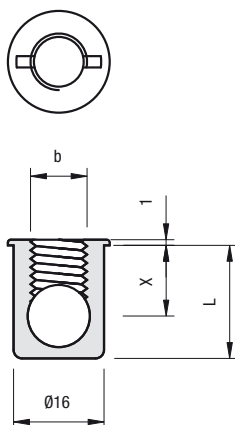

	ART.	∅	X	b	L		
Zama	311	22	16	11	10MA	19,5	2.000
	312	24-25	16	12	10MA	20,5	2.000
	313	26-28	16	13	10MA	21,5	2.000
	315	30	16	15	10MA	23,5	1.000

Grano 10MA

Conic screw 10MA

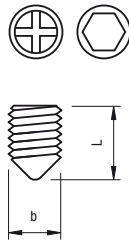

	ART.	L	b			
Zama	361	11	10MA		4.000	
Acciaio	362	12	10MA		EX 5	4.000
	363	14	10MA		EX 5	4.000
	364	16	10MA		EX 5	4.000

Astina Ø 10

Pin Ø 10

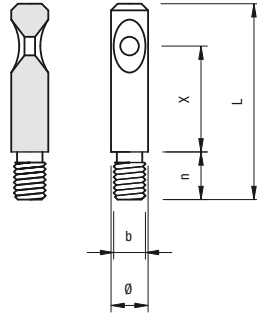

	ART.	Ø	L	b	X	
Acciaio	321	10	36	6MA	20	1.000
	322	10	36	8MA	20	1.000
	323	10	36	7/16	20	1.000
	331	10	41	6MA	25	1.000
	332	10	41	8MA	25	1.000
	333	10	41	7/16	25	1.000
	341	10	46	6MA	30	1.000
	342	10	46	8MA	30	1.000
	344	10	55	8MA	35	500
	345	10	55	8MA	38	500
	10	A disegno / On drawing				

Barilotto Ø 14 senza bordo

Housing Ø 14 wo/rim

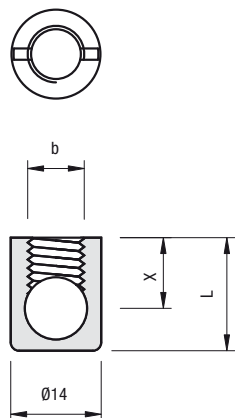

	ART.	∅	X	b	L		
Zama	401	16	14	8	8MA	14	2.000
	402	18	14	9	8MA	15	2.000
	403	20	14	10	8MA	16	2.000
	404	22	14	11	8MA	17	2.000
	405	25	14	12,5	8MA	19	2.000
	411	16	14	8	8P1	14	2.000
	412	18	14	9	8P1	15	2.000
	413	20	14	10	8P1	16	2.000

Barilotto Ø 14 con bordo

Housing Ø 14 w/rim

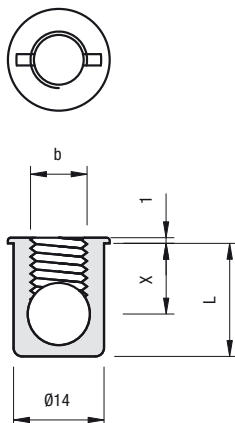

	ART.	∅	X	b	L		
Zama	421	16	14	8	8MA	14	2.000
	422	18	14	9	8MA	15	2.000
	423	20	14	10	8MA	16	2.000
	424	22	14	11	8MA	17	2.000
	425	25	14	12,5	8MA	19	2.000
	428	28/30	14	15	8MA	20,5	1.000
	431	16	14	8	8P1	14	2.000
	432	18	14	9	8P1	15	2.000
	433	20	14	10	8P1	16	2.000

Grano 8MA / 8P1

Conic screw 8MA / 8P1

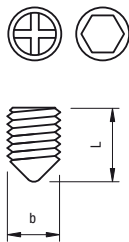

	ART.	L	b		
Zama	439	9	8MA		10.000
	440	11	8MA		10.000
	441	15	8MA		5.000
	442	11	8MA		10.000
	450	11	8P1		10.000
	451	8	8P1		10.000
Acciaio	447	10	8MA	EX 4	10.000
	448	12	8MA	EX 4	10.000

Astina Ø 7 - Ø 7,5

Pin Ø 7 - Ø 7,5

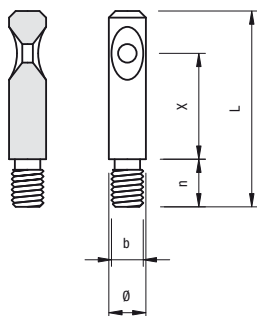

	ART.	Ø	L	b	X	
Acciaio	461	7	35	6MA	18,5	2.000
	462	7	35	6MA	20	2.000
	463	7	39	FL6	20	2.000
	464	7	45	6MA	30	2.000
	465	7	45	6MA	28	2.000
	466	7	60	6MA	44	1.000
	467	7	70	6MA	54	1.000
		7	A disegno / On drawing			
Acciaio	468	7,5	34	6MA	20	2.000
	469	7,5	36	6MA	20	2.000
		7,5	A disegno / On drawing			